

This document, together with the concepts and designs presented herein, is intended only for the specific purpose and client for which it was prepared. Review of and/or incorporation into other documents without the written authorization and approval of Kimley-Horn and Associates, Inc. shall be without liability to Kimley-Horn and Associates, Inc.

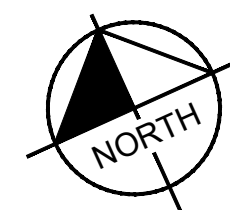

	PROP FULL DEPTH PAVEMENT		PROP RETAINING WALL		PROP DITCH
	PROP CONC SIDEWALK, MEDIANS, AND ISLANDS		PROP STORM DRAIN		EXIST ROW
	PROP GRADING		PROP PERM. EASEMENT		EXIST CURB/EDGE OF PAVEMENT
	PROP SHARED USE PATH		PROP ROW		FEMA 100-YR FLOODPLAIN
	PROP MILL AND OVERLAY		PROP TEMP. ESMT.		PREDICTED WETLANDS
	PROP CURB & GUTTER		PROP DRAINAGE STRUCTURE		EXISTING UTILITY

PRINCE WILLIAM PARKWAY AND CLOVER HILL ROAD BOWTIE INTERSECTION  
MARCH 31, 2022

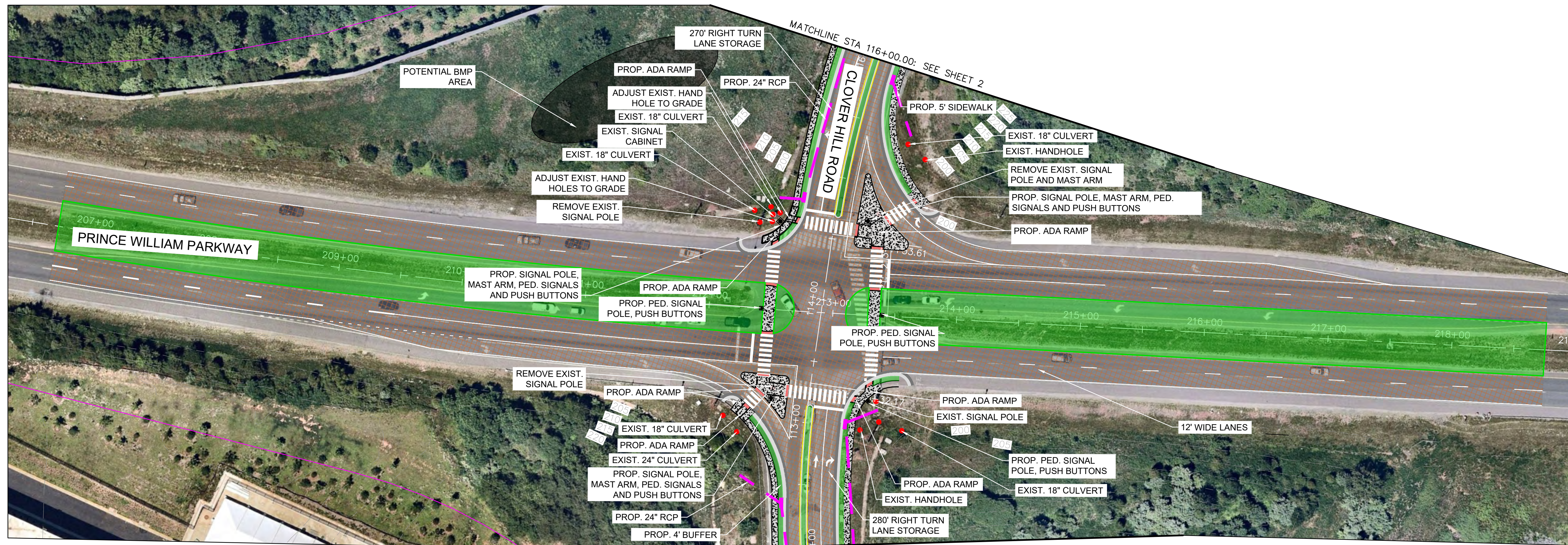
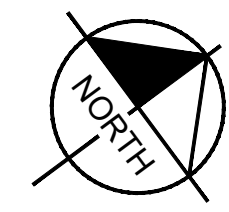
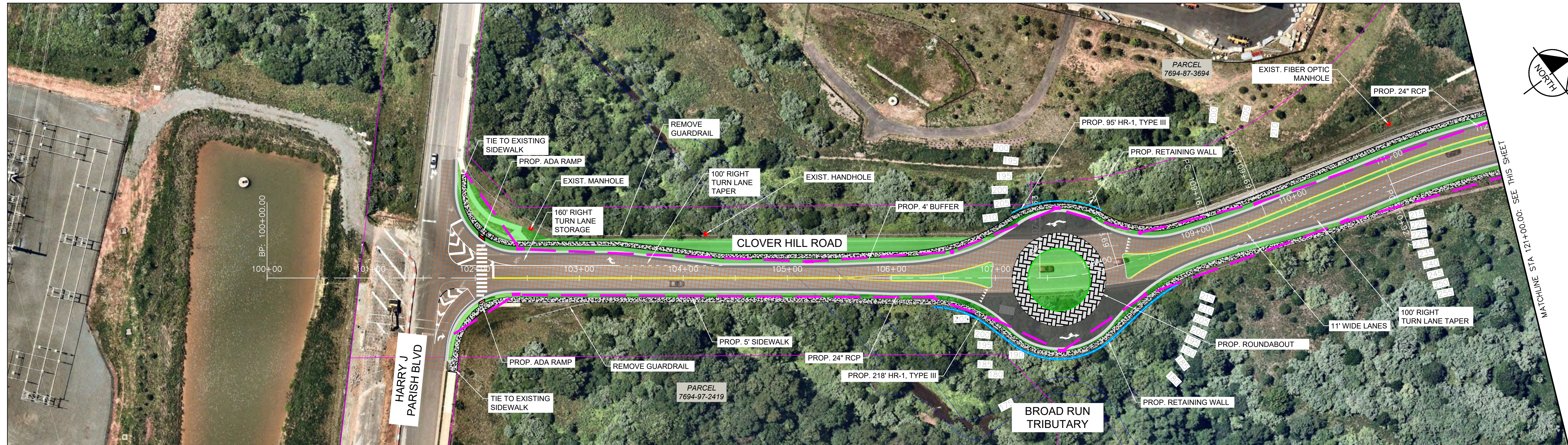
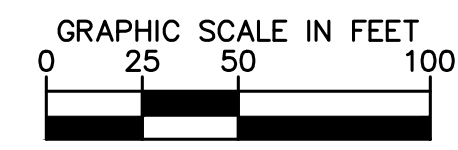

Kimley >> Horn

SHEET NUMBER

1

This document, together with the concepts and designs presented herein, is intended only for the specific purpose and client for which it was prepared. Reuse of any information contained herein without the written authorization and approval of Kimley-Horn and Associates, Inc. shall be without liability to Kimley-Horn and Associates, Inc.

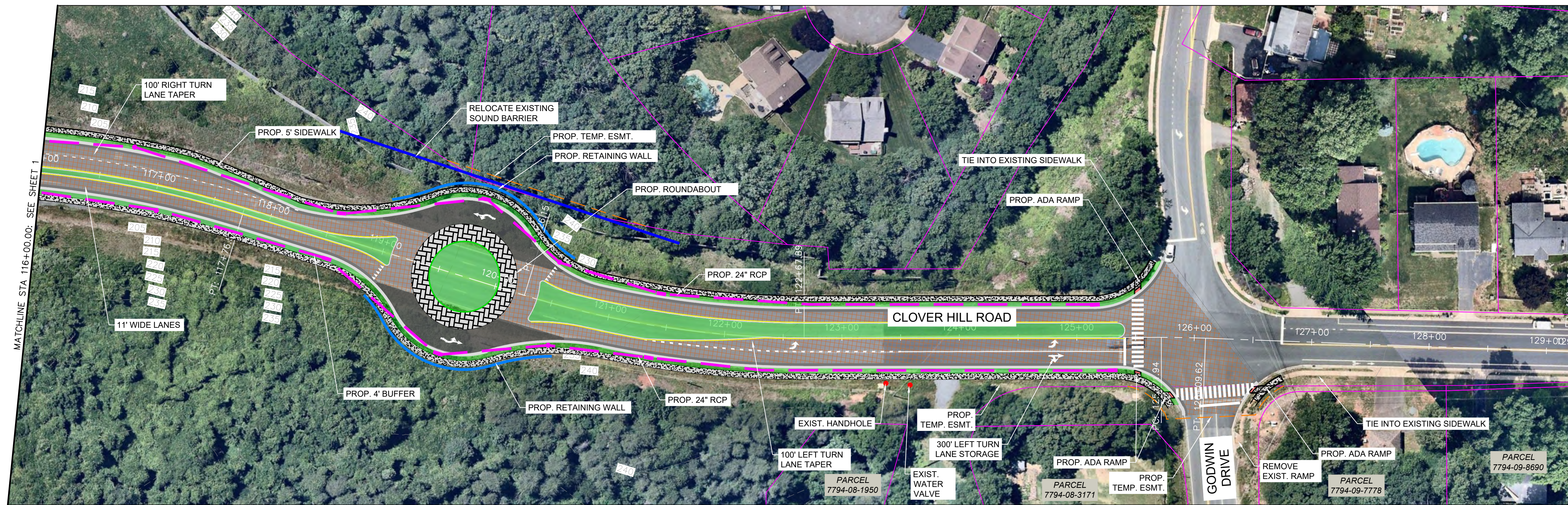

**DRAFT**  
THIS CONCEPTUAL PLAN WAS PRODUCED FOR DISCUSSION PURPOSES ONLY.

	PROP FULL DEPTH PAVEMENT		PROP RETAINING WALL		PROP DITCH
	PROP CONC SIDEWALK, MEDIANS, AND ISLANDS		PROP STORM DRAIN		EXIST ROW
	PROP GRADING		PROP PERM. EASEMENT		EXIST CURB/EDGE OF PAVEMENT
	PROP SHARED USE PATH		PROP ROW		FEMA 100-YR FLOODPLAIN
	PROP MILL AND OVERLAY		PROP TEMP. ESMT.		PREDICTED WETLANDS
	PROP CURB & GUTTER		PROP DRAINAGE STRUCTURE		EXISTING UTILITY

PRINCE WILLIAM PARKWAY  
AND CLOVER HILL ROAD  
BOWTIE INTERSECTION  
MARCH 31, 2022

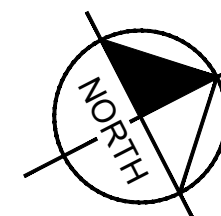
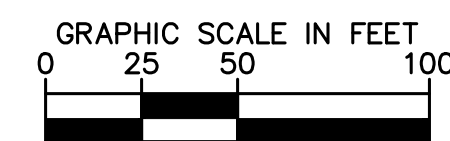

**Kimley»Horn**

SHEET NUMBER

2